

KRISLON HOUSE

A MILESTONE FOR LARGE CORPORATES



KRISLON[®]
GROUP

FOR CORPORATES WHO THINKS BIG

A STATE-OF-THE-ART CORPOARTE CENTER

BETTER BUSINESS POTENTIAL 1,50,000 SQFT. LARGE CORPORATE, 6 UNITS ON EACH FLOOR, WITH 4 FLOORS EACH UNIT OF 5000 SQFT. ON SAKI VIHAR ROAD, ANDHERI EAST, NEAR LEELA KEMPENSKI, GROUND FLOOR AMPLE PARKING, CAFETERIA, HEALTH CLUB, COMMERCIAL CENTER, 4 LIFTS INTERNAL, 4 STAIRCASES.

KRISLON HOUSE A HI-TECH COMMERCIAL COMPLEX DESIGNED FOR LARGE CORPORATES.



PROPOSED OFFICE DESIGNS ON 5000 SQFT AREA



LOCATION PLAN



2 KMS FROM INTERNATIONAL AIRPORT, HOTEL LEELA KEMPENSKI, GRAND MARATHA SHERATON & HIRANANDANI RESIDENTIAL COMPLEX, EQUI DISTANCE FROM WESTERN RLY. ANDHERI STATION AND EASTERN RLY. KURLA AND GHATKOPHAR STATION.

UNMATCHED INTERNATIONAL INFRASTRUCTURE

WELCOME TO KRISLON HOUSE A COMPLETE INTERNATIONALLY
DESIGNED OFFICE COMPLEX WITH UNMATCHED
INTERNATIONAL QUALITY INFRASTRUCTURE

DISTINCTIVE DESIGN & FACILITIES

FEATURES	
Floor to Floor Height	12ft
Air Conditioning	Central Airconditioning
Power	Ample Power Available Duel Feed From BSES and TATA, Sub station on site and earthing provided
Floor Plate	30,000 sq. ft. divided into 6 Blocks of 5000 sq. ft. each, i.e. space available in multiples of 5000 sq. ft. per floor.
Connectivity	Broad Band Optical Fibre Network for Voice Data Transfer and Video conferencing.
Telephone Lines	Availble as many as required
Cabling	Optional - might be done by the occupier themselves as required.
Last Mile Linkage	Fiber optic cable
Parking	Ample Parking space available
Building Security	24 hours
Fire Safety	Fire safety provided
Amenities	State-of- the-art fitness center, Cafeteria, Recreation center, "V" Sat. antenna Ample space available on tarrace.
Water	24 hours water supply
Adaptability	Individuals specific requirments such as Wiring, Flooring, Air-conditioning, etc.

OUR PLANS

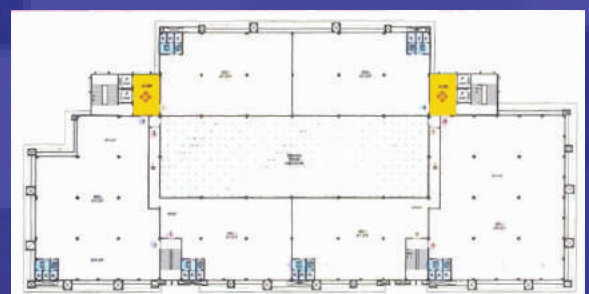
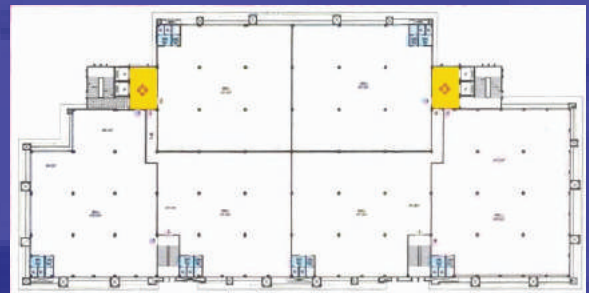
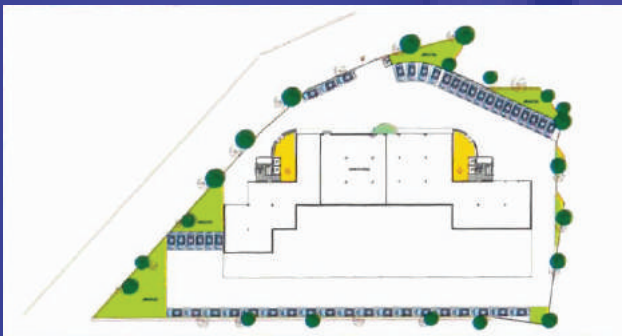

KRISLON[®]
H O U S E
FOR CORPORATES WHO THINKS BIG

OUR PRESTIGIOUS MULTINATIONAL CLIENTS

- EVONIK INDIA PVT. LTD.
- L & T
- ASAAN JOB
- SMARTPADDLE TECHNOLOGY
- TATA 1mg
- IMS
- TOPCOAT
- OSLAB TECHNOLOGY

KRISLON[®] GROUP

Various Business activities of the Krislon Group are in Technical Collaboration with world leaders,

M/s. Shinwa Rule Company of Japan,
M/s. Metal Etching Technology Associates Inc. of USA.,
M/s. Micro Circuit Engineering Corporation of USA.,
M/s. RPR Officine Meccaniche Riva S.R.L of ITALY



A VENTURE OF KRISLON GROUP

KRISLON[®]
H O U S E
FOR CORPORATES WHO THINKS BIG

KRISLON HOUSE, SAKI VIHAR ROAD, SAKI NAKA, MUMBAI - 400072, INDIA.

Mobile No. +91 88797 60523 | Tel. No. +91 22 4225 6666/6613

Email: sales@kristeel.com | Visit us at: www.kristeel.com